



# Bortsheller Shoreline and Hillside Stabilization

Wyanett Township, Isanti County



Shoreline and Hillside Stabilization

## Project Summary

This project is located at the Spectacle Lake on private property. The project includes stabilizing the shoreline and hillside. The goal of the project is to protect the health of Spectacle Lake by capturing and filtering rainwater runoff, and reducing erosion to the hillside and shoreline.

This project was completed as part of a \$93,532 Clean Water Fund Grant. The grant goal was to protect the health of Spectacle Lake, the “Gem” of Isanti County. The lake was identified by the DNR as “likely to see declines in water quality trends” as development and redevelopment occurs.

The private landowner is among several partners on Spectacle that have dedicated resources towards protecting lake health.

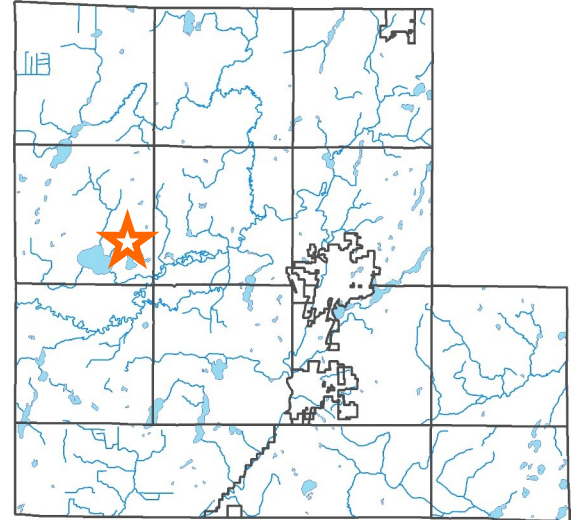

Project Location

<u>Project Details</u>	<u>Project Funding</u>	<u>Pollutant Reduction</u>
<b>Target Water:</b> Spectacle Lake	<b>Clean Water Fund :</b> \$5,962.50	<b>Phosphorus:</b> .59 lbs/yr
<b>Date Installed:</b> August 2023	<b>Landowner:</b> \$1,987.50	<b>Sediment:</b> 1,960 lbs/yr
<b>Project Size:</b> 1250 Sq Ft	<b>Total:</b> \$7,950.00	<b>Volume:</b> NA



1050 native plants installed to stabilize hillside and shoreline to prevent erosion.



1050 native plants installed to uptake nutrients and improve wildlife/pollinator habitat.